

**PLAN SHOWING PROPOSED CHANGES TO PARKING RESTRICTION
WESTERN ROAD (PLAN I)**

KEY:- x x x x x PROPOSED NO LOADING/UNLOADING 7AM TO 10AM AND 4PM TO 7PM

REASON:- TO PREVENT OBSTRUCTION DURING PEAK TIMES

SCALE : NOT TO SCALE REFER ONLY TO MEASUREMENTS

Reproduction from the Ordnance Survey mapping with the Permission of the Controller of H.M. Stationery Office. © Crown Copyright. Unauthorised reproduction infringes Crown copyright and may lead to prosecution or Civil Proceedings. Brighton & Hove Council. Licence : LA09068L, 2003.





**PLAN SHOWING PROPOSED CHANGES TO PARKING RESTRICTION
WESTERN ROAD (PLAN 2)**

KEY:- x x x x x PROPOSED NO LOADING/UNLOADING 7AM TO 10AM AND 4PM TO 7PM

REASON:- TO PREVENT OBSTRUCTION DURING PEAK TIMES

SCALE : NOT TO SCALE REFER ONLY TO MEASUREMENTS

Reproduction from the Ordnance Survey mapping with the Permission of the Controller of H.M. Stationery Office. © Crown Copyright . Unauthorised reproduction infringes Crown copyright and may lead to prosecution or Civil Proceedings. Brighton & Hove Council. Licence : LA09068L, 2003.



168

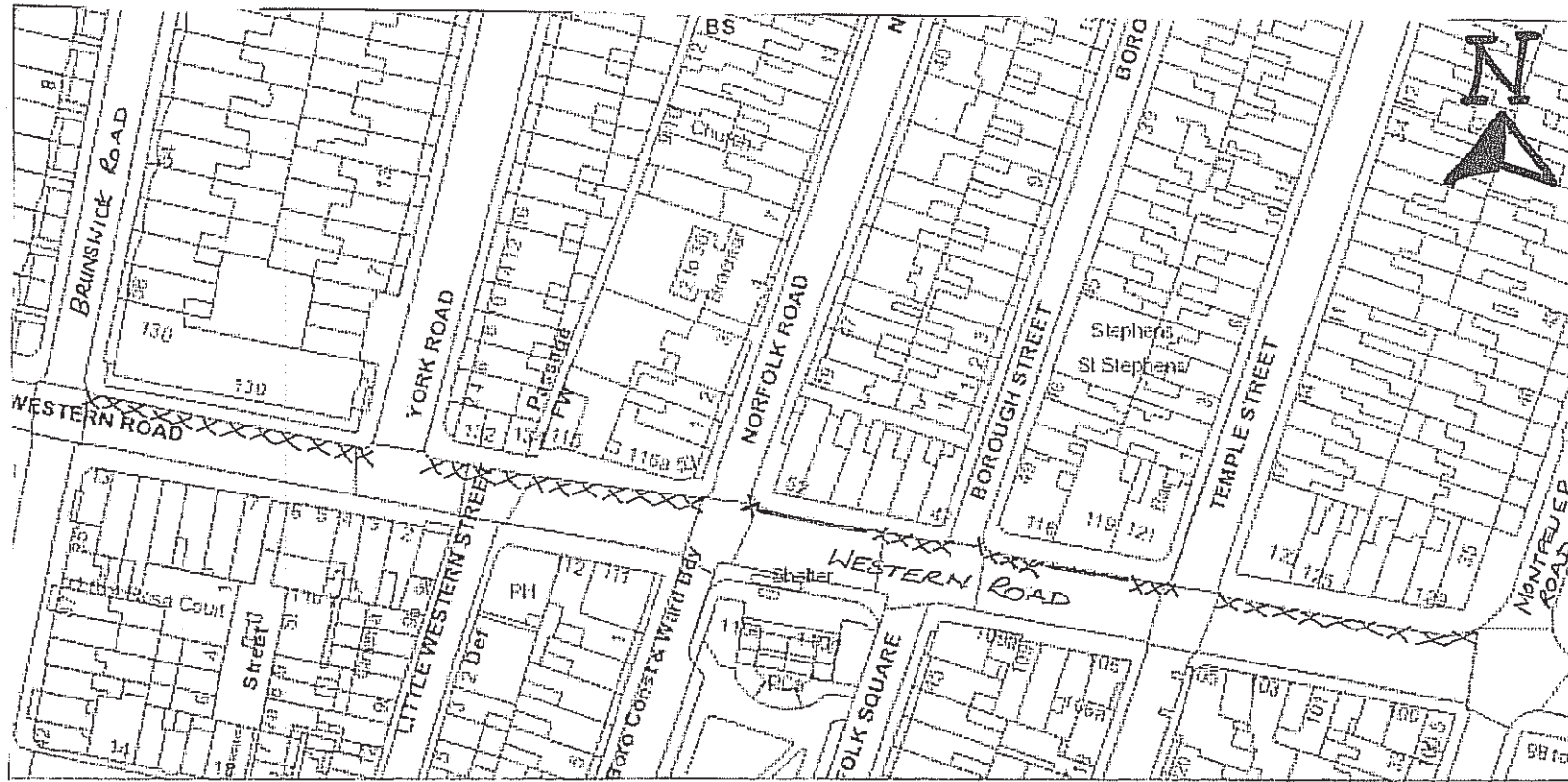

PLAN SHOWING PROPOSED CHANGES TO PARKING RESTRICTION WESTERN ROAD (PLAN 3)

KEY:- x x x x x PROPOSED NO LOADING/UNLOADING 7AM TO 10AM AND 4PM TO 7PM
————— EXISTING SINGLE YELLOW LINES

REASON:- TO PREVENT OBSTRUCTION DURING PEAK TIMES

SCALE : NOT TO SCALE REFER ONLY TO MEASUREMENTS

Reproduction from the Ordnance Survey mapping with the Permission of the Controller of H.M. Stationery Office. © Crown Copyright . Unauthorised reproduction infringes Crown copyright and may lead to prosecution or Civil Proceedings. Brighton & Hove Council. Licence : LA0906BL, 2003.

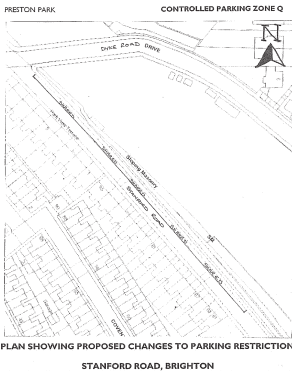

KEY:  PROPOSED CHANGE TO THE EXISTING 4 HOURS SHARED PARKING BAYS TO 11 HOURS SHARED PARKING BAYS

REASON- TO PROVIDE AN AREA OF LONG TERM PARKING FOR NEARBY FACILITIES

SCALE- NOT TO SCALE REFER ONLY TO MEASUREMENTS

PRESTON PARK

CONTROLLED PARKING ZONE

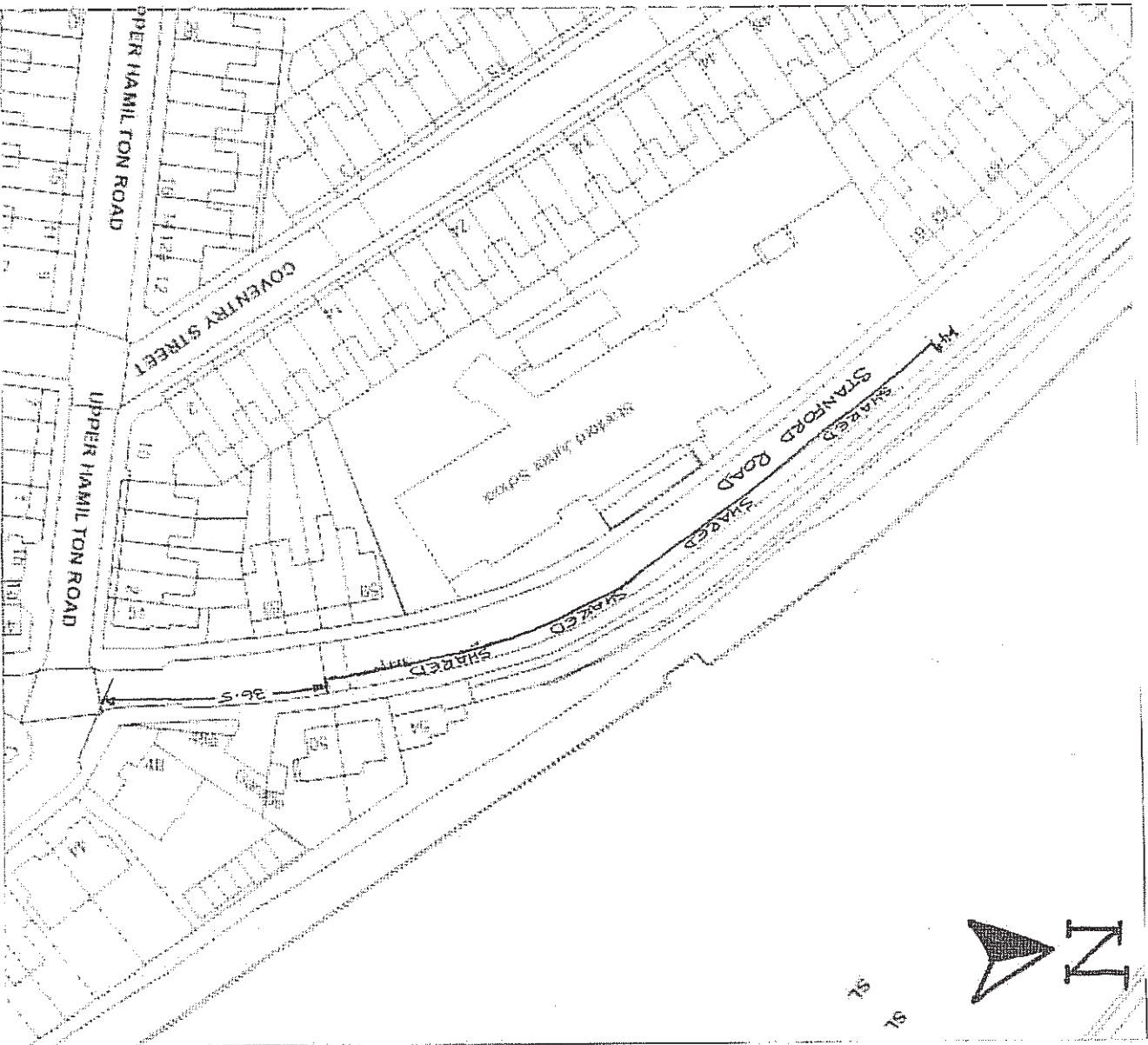

PLAN SHOWING PROPOSED CHANGES TO PARKING RESTRICTION

STANFORD ROAD, BRIGHTON

KEY:-  **SHARED**
PROPOSED CHANGE TO THE EXISTING 4 HOURS SHARED PARKING BAYS TO
11 HOURS SHARED PARKING BAYS

REASON:- TO PROVIDE AN AREA OF LONG TERM PARKING FOR NEARBY FACILITIES

SCALE : NOT TO SCALE REFER ONLY TO MEASUREMENTS

Reproduction from the Ordnance Survey mapping with the Permission of the
Controller of H.M. Stationery Office. © Crown Copyright. Unauthorised
reproduction infringes Crown copyright and may lead to prosecution or Civil
Proceedings. Brighton & Hove Council. Licence : LA09068L. 2003.

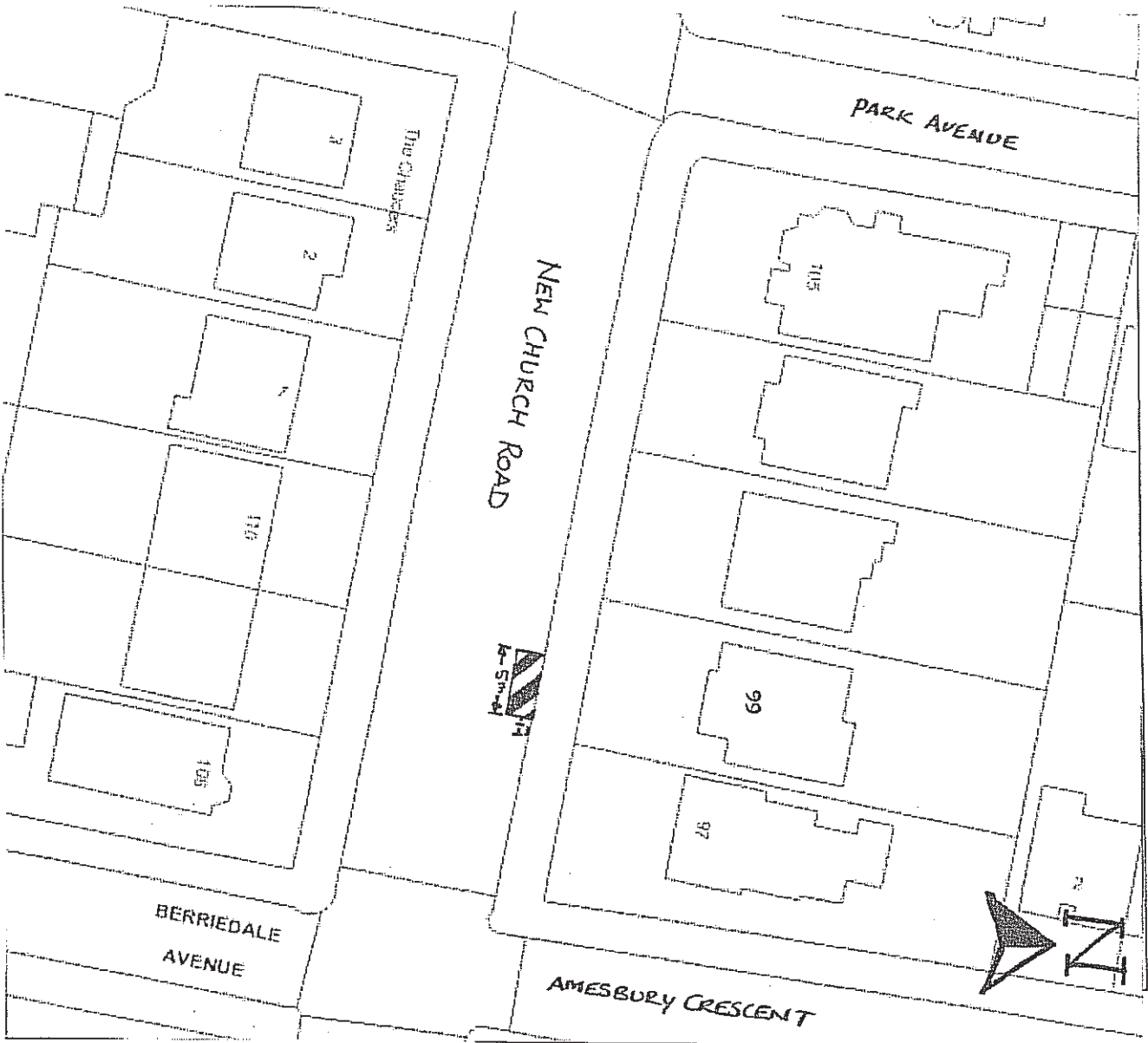

**PLAN SHOWING PROPOSED CHANGES TO PARKING RESTRICTION
NEW CHURCH ROAD, HOVE**

KEY:-  PROPOSED RELOCATION OF PERMIT PARKING BAY

REASON:- RELOCATING DUE TO A REQUEST

SCALE: NOT TO SCALE REFER ONLY TO MEASUREMENTS

Reproduction from the Ordnance Survey mapping with the Permission of the Controller of HM Stationery Office. © Crown Copyright. Unauthorised reproduction infringes Crown copyright and may lead to prosecution or Civil Proceedings. Brighton & Hove Council. Licence : LA0906BL, 2003.

HANGLETON & KNOLL

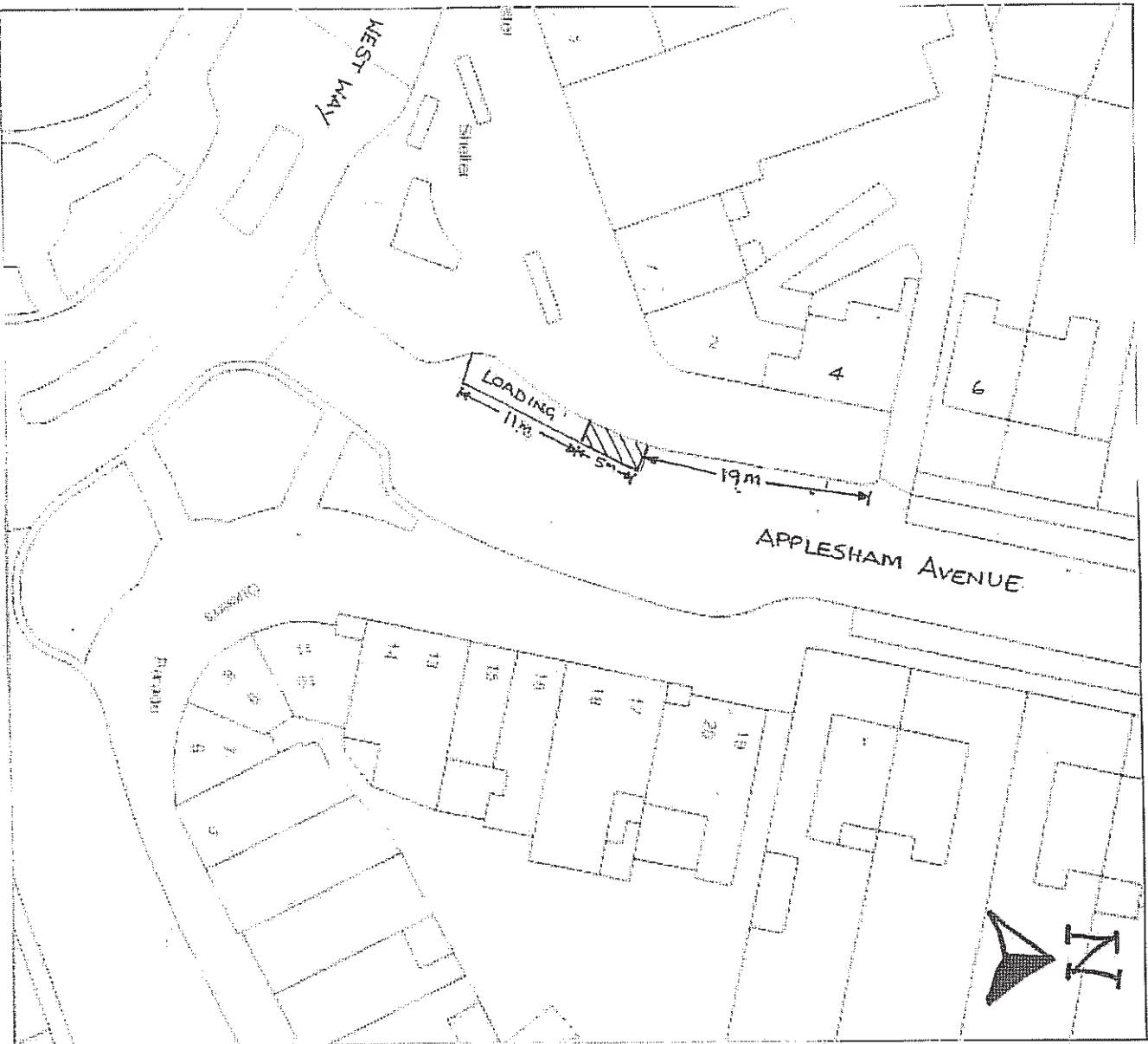

PLAN SHOWING PROPOSED CHANGES TO PARKING RESTRICTION

APPLESHAM AVENUE, HOVE

KEY:- PROPOSED EXTEND TO LOADING BAY



EXISTING LOADING BAY

REASON:- TO EXTEND THE LOADING BAY TO ALLOW FOR LARGER DELIVERY VEHICLES

SCALE : NOT TO SCALE REFER ONLY TO MEASUREMENTS

Reproduction from the Ordnance Survey mapping with the Permission of the Controller of H.M. Stationery Office. © Crown Copyright. Unauthorised reproduction infringes Crown copyright and may lead to prosecution or Civil Proceedings. Brighton & Hove Council. Licence : LA09068L, 2003.

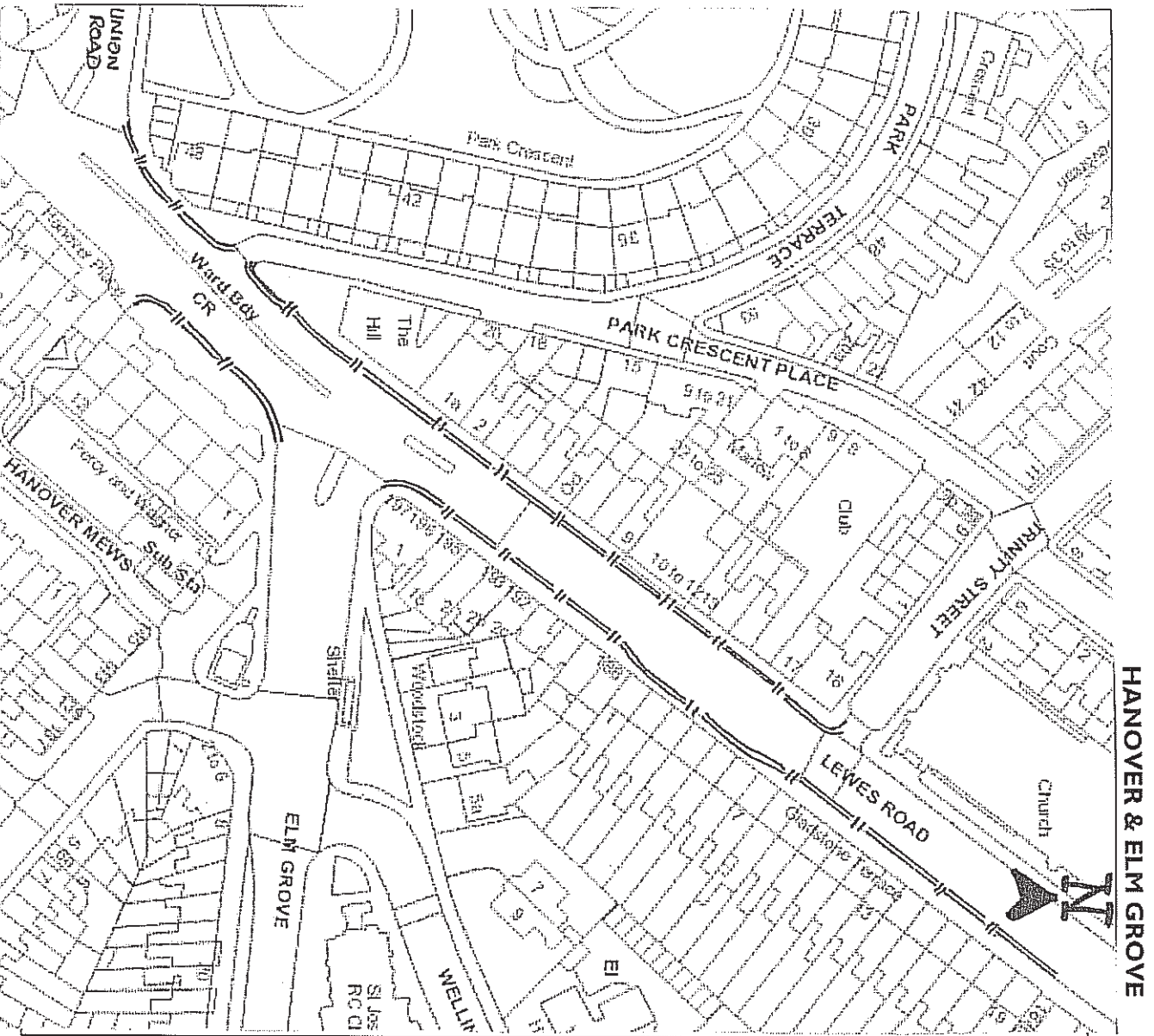

**PLAN SHOWING PROPOSED CHANGES TO PARKING RESTRICTION
LEWES ROAD, BRIGHTON (PLAN 1)**

KEY:-  PROPOSED NO LOADING/UNLOADING MON - SAT 7AM - 10AM & 4PM - 7PM

REASON:- TO PREVENT OBSTRUCTION DURING PEAK TIMES

SCALE: NOT TO SCALE REFER ONLY TO MEASUREMENTS

Please see formal notice, to see what other roads have restrictions proposed, where to view the plans and traffic order and how to object or support this proposal

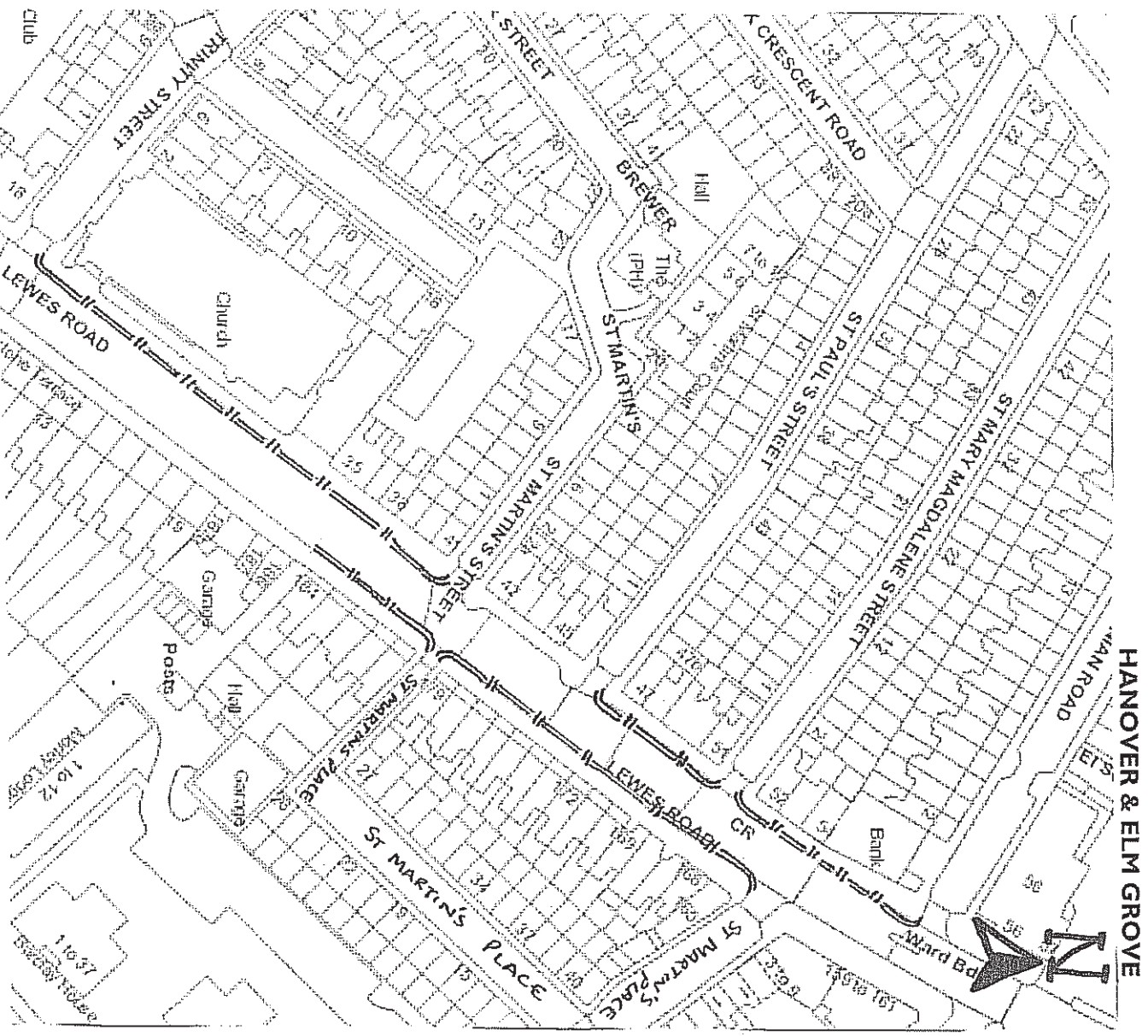

**PLAN SHOWING PROPOSED CHANGES TO PARKING RESTRICTION
LEWES ROAD, BRIGHTON (PLAN 2)**

KEY: PROPOSED NO LOADING/UNLOADING MON - SAT 7AM - 10AM & 4PM - 7PM

REASON: TO PREVENT OBSTRUCTION DURING PEAK TIMES

SCALE : NOT TO SCALE REFER ONLY TO MEASUREMENTS

Please see formal notice, to see what other roads have restrictions proposed, where to view the plans and traffic order and how to object or support this proposal

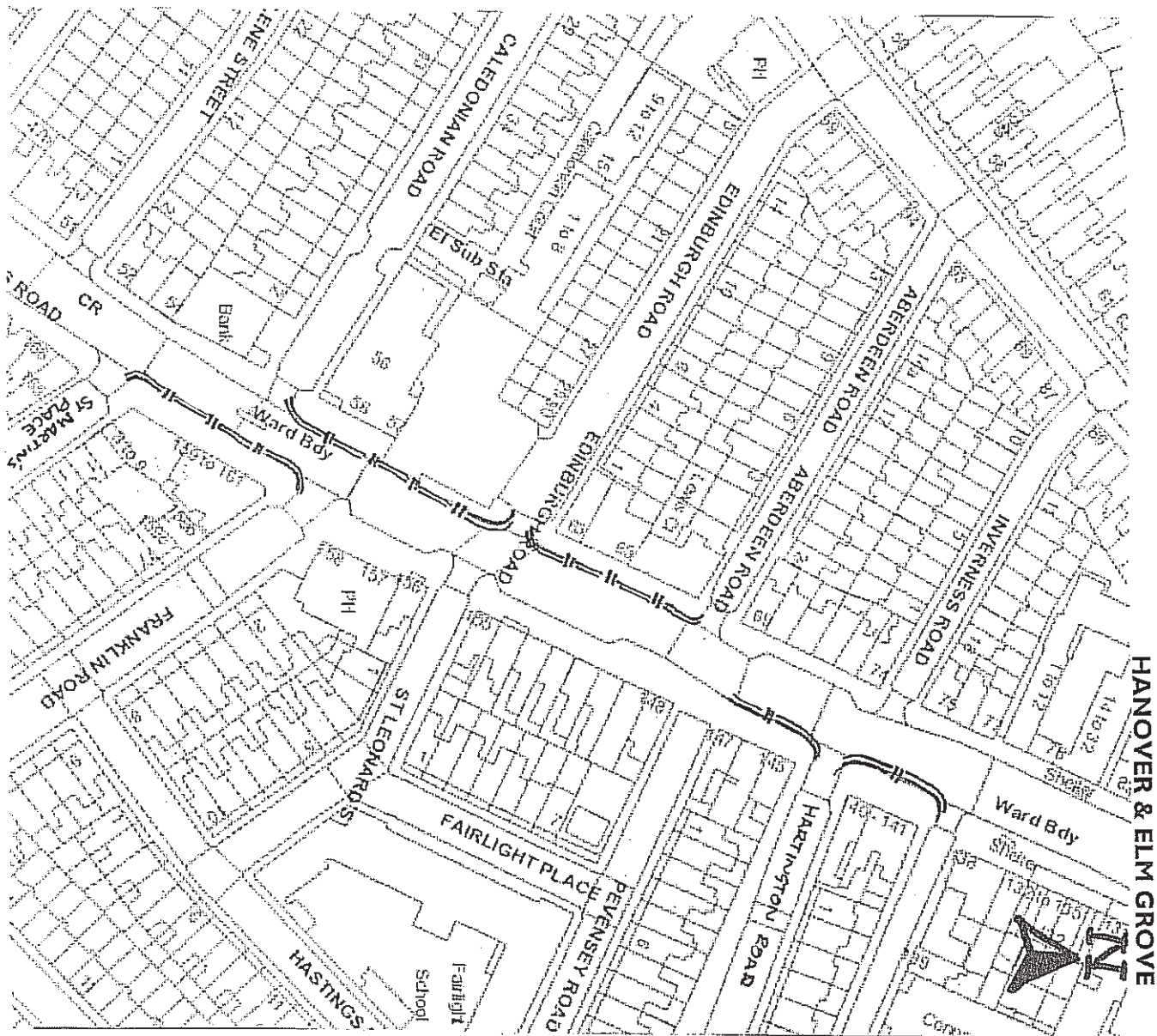

**PLAN SHOWING PROPOSED CHANGES TO PARKING RESTRICTION
LEWES ROAD, BRIGHTON (PLAN 3)**

KEY:  PROPOSED NO LOADING/UNLOADING MON - SAT 7AM - 10AM & 4PM – 7PM

REASON: TO PREVENT OBSTRUCTION DURING PEAK TIMES

SCALE : NOT TO SCALE REFER ONLY TO MEASUREMENTS

Please see formal notice, to see what other roads have restrictions proposed, where to view the plans and traffic order and how to object or support this proposal

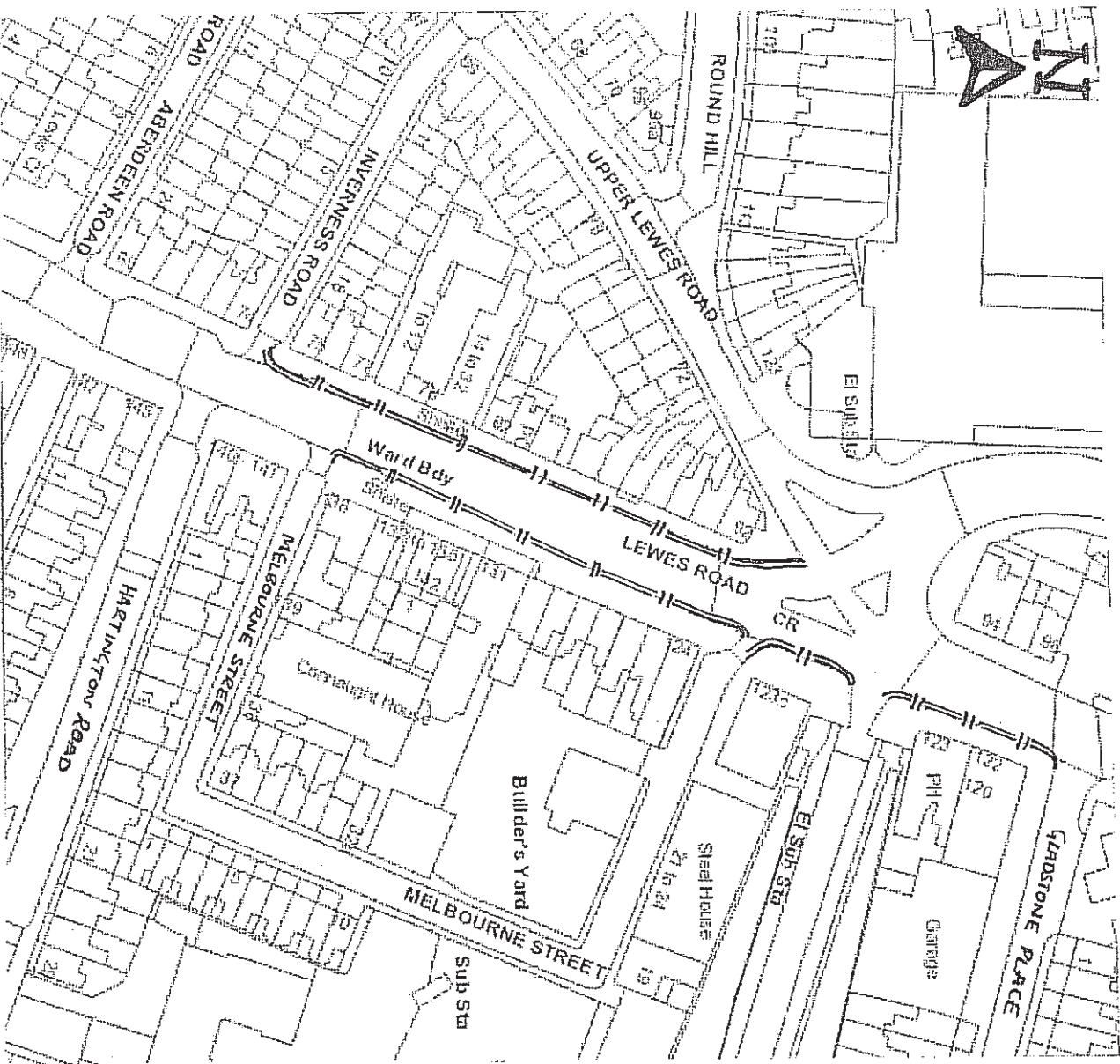

**PLAN SHOWING PROPOSED CHANGES TO PARKING RESTRICTION
LEWES ROAD, BRIGHTON (PLAN 4)**

KEY:  PROPOSED NO LOADING/UNLOADING MON - SAT 7AM - 10AM & 4PM - 7PM

REASON: TO PREVENT OBSTRUCTION DURING PEAK TIMES

SCALE: NOT TO SCALE REFER ONLY TO MEASUREMENTS

Please see formal notice, to see what other roads have restrictions proposed, where to view the plans and traffic order and how to object or support this proposal

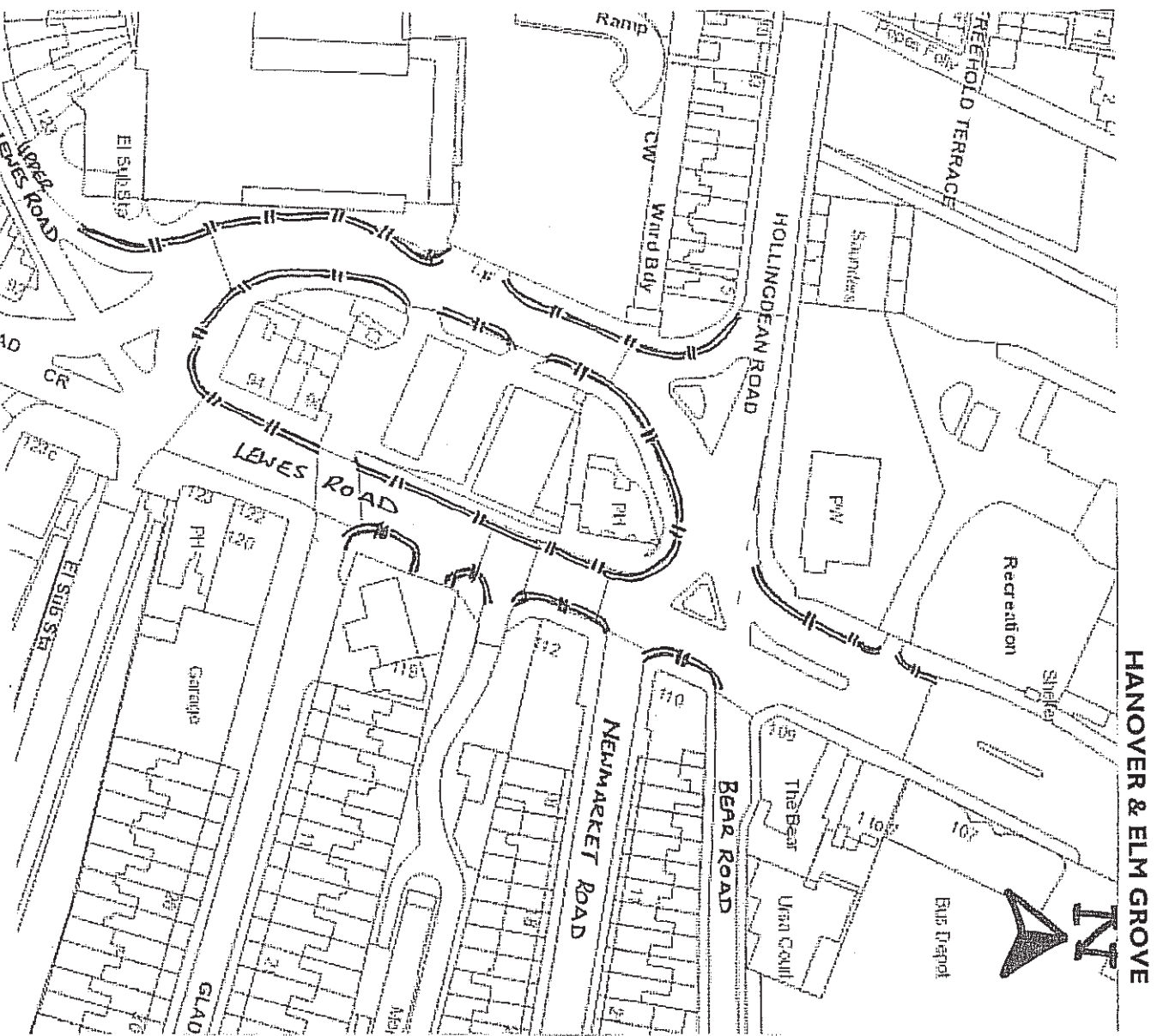

PLAN SHOWING PROPOSED CHANGES TO PARKING RESTRICTION
LEWES ROAD, BRIGHTON (PLAN 5)

KEY:- PROPOSED NO LOADING/UNLOADING MON - SAT 7AM - 10AM & 4PM - 7PM

REASON:- TO PREVENT OBSTRUCTION DURING PEAK TIMES

SCALE : NOT TO SCALE REFER ONLY TO MEASUREMENTS

Please see formal notice, to see what other roads have restrictions proposed, where to view the plans and traffic order and how to object or support this proposal

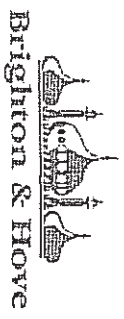

Reproduction from the Ordnance Survey mapping with the Permission of the Controller of H.M. Stationery Office. © Crown Copyright. Unauthorised reproduction infringes Crown copyright and may lead to prosecution or Civil Proceedings. Brighton & Hove Council. Licence : LA07068L, 2003.

NORTH PORTSLADE

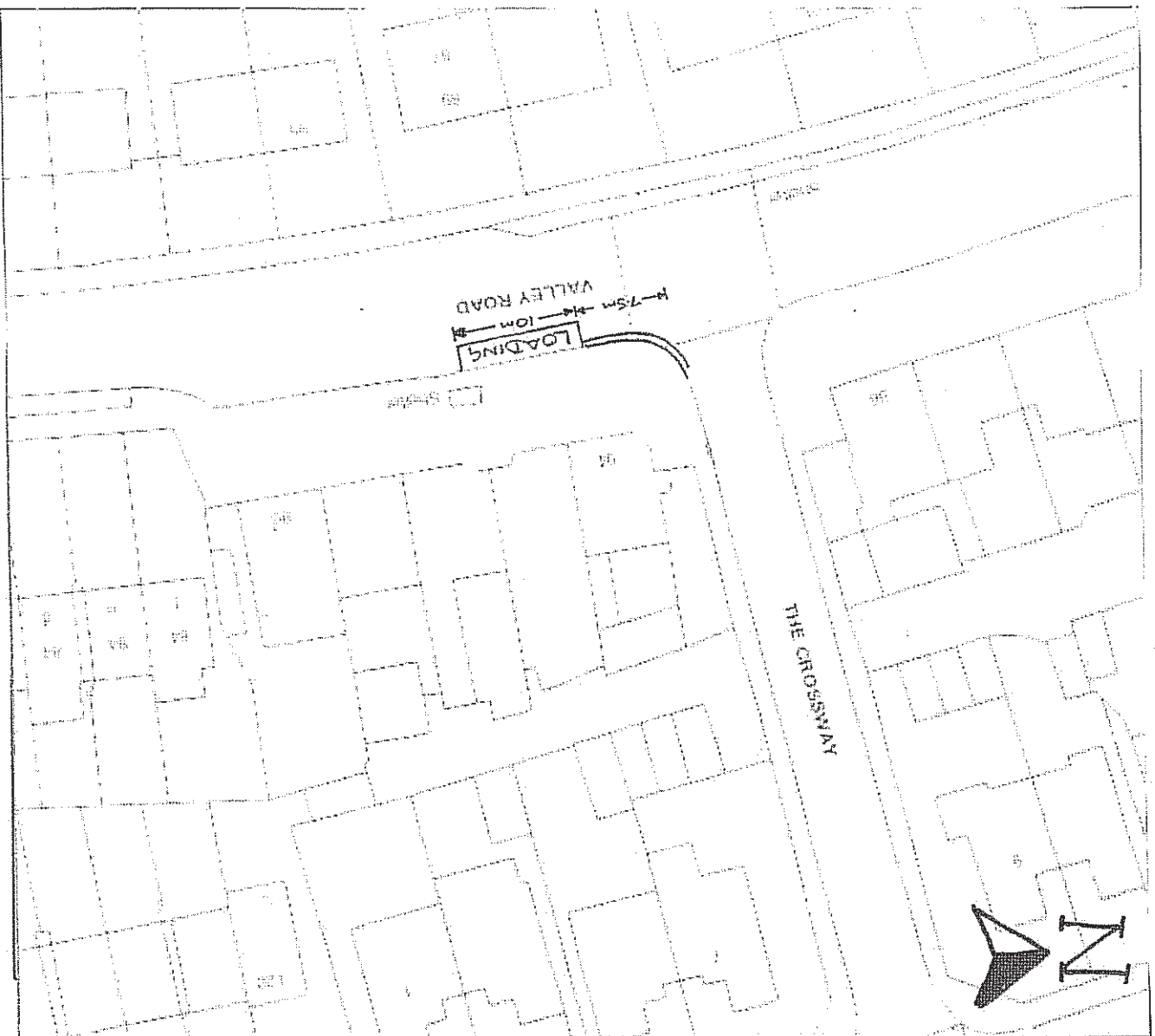

**PLAN SHOWING PROPOSED CHANGES TO PARKING RESTRICTION
VALLEY ROAD, PORTSLADE**

KEY:- LOADING PROPOSED LOADING BAY

REASON:- TO PROVIDE A LOADING BAY FOR NEARBY FACILITIES

SCALE : NOT TO SCALE REFER ONLY TO MEASUREMENTS

Reproduction from the Ordnance Survey mapping with the Permission of the Controller of H.M. Stationery Office. © Crown Copyright. Unauthorised reproduction infringes Crown copyright and may lead to prosecution or Civil Proceedings. Brighton & Hove Council. Licence : LA090681, 2003.

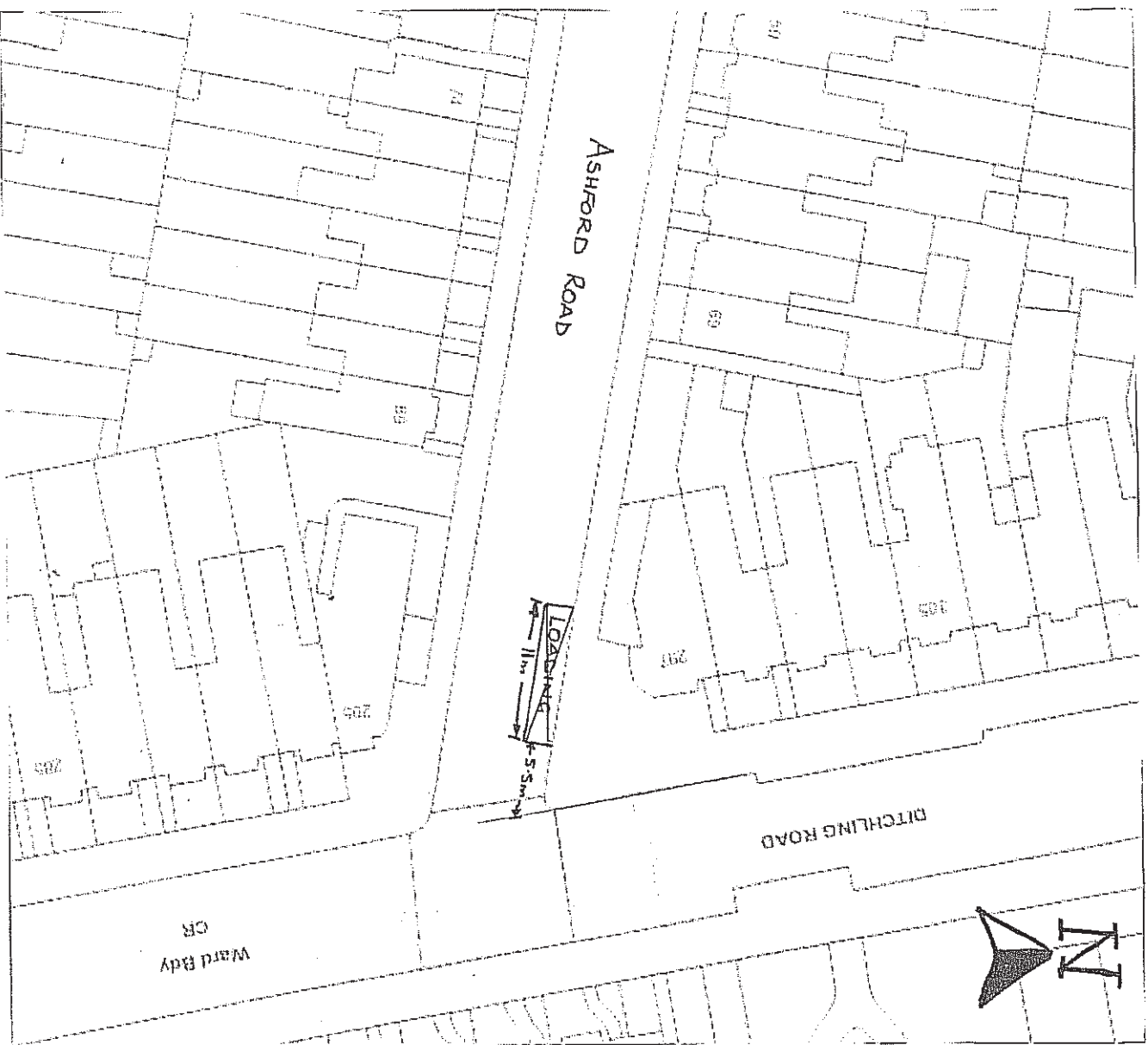

PLAN SHOWING PROPOSED CHANGES TO PARKING RESTRICTION
ASHFORD ROAD, BRIGHTON

KEY:-  PROPOSED REMOVAL OF LOADING BAY

REASON:- TO REMOVE LOADING BAY HAS NO LONGER REQUIRED

SCALE: NOT TO SCALE REFER ONLY TO MEASUREMENTS

Reproduction from the Ordnance Survey mapping with the Permission of the Controller of H.M. Stationery Office. © Crown Copyright. Unauthorised reproduction infringes Crown copyright and may lead to prosecution or Civil Proceedings. Brighton & Hove Council. Licence: LA09068L, 2003.

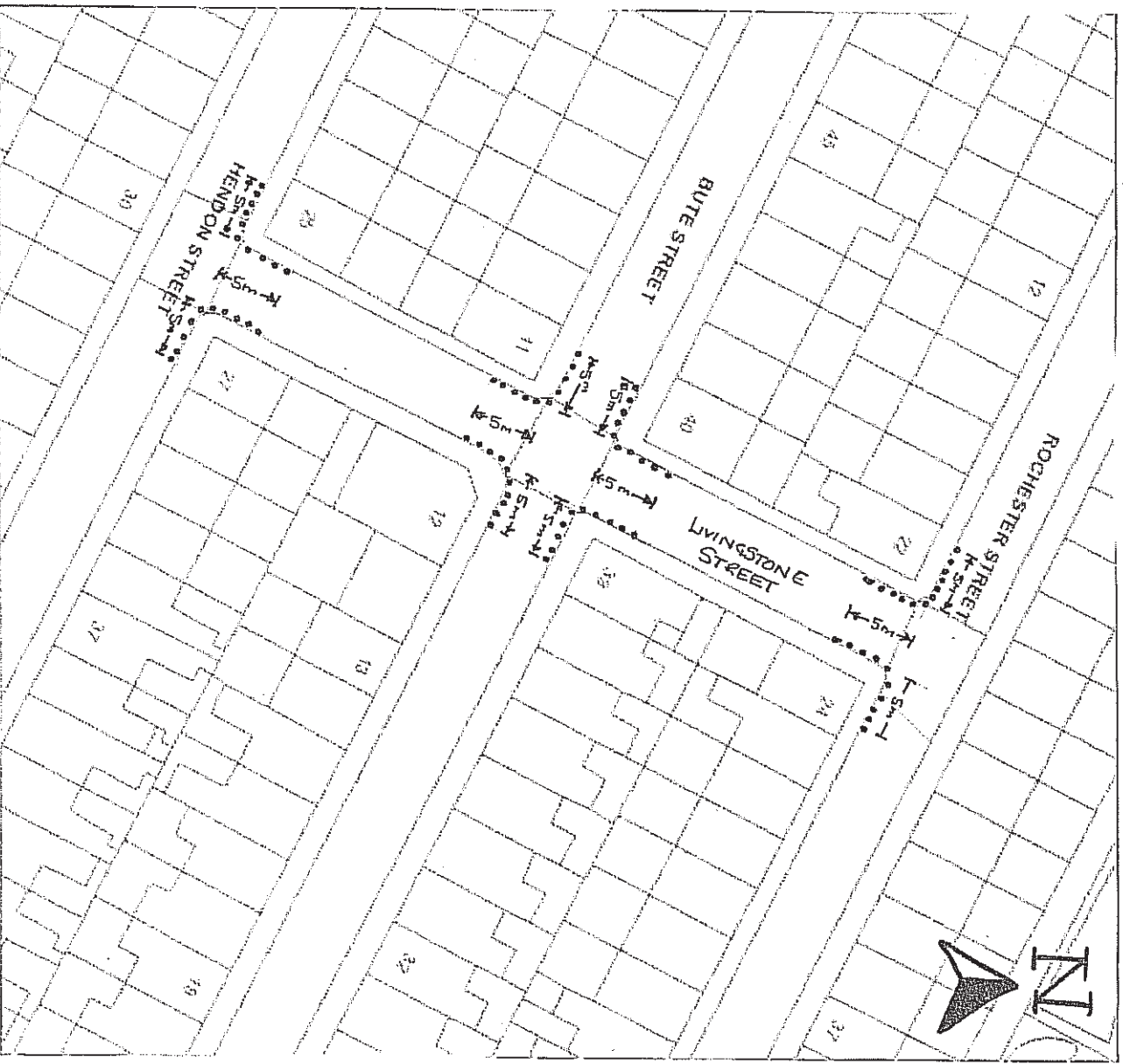

**PLAN SHOWING PROPOSED CHANGES TO PARKING RESTRICTION
LIVINGSTONE STREET/HENDON STREET/BUTE STREET/ROCHESTER STREET,
BRIGHTON**

KEY:- PROPOSED DOUBLE YELLOW LINES

REASON:- TO PREVENT OBSTRUCTION

SCALE: NOT TO SCALE REFER ONLY TO MEASUREMENTS

Please see formal notice, to see what other roads have restrictions proposed, where to view the plans and traffic notice and how to object or support this proposal

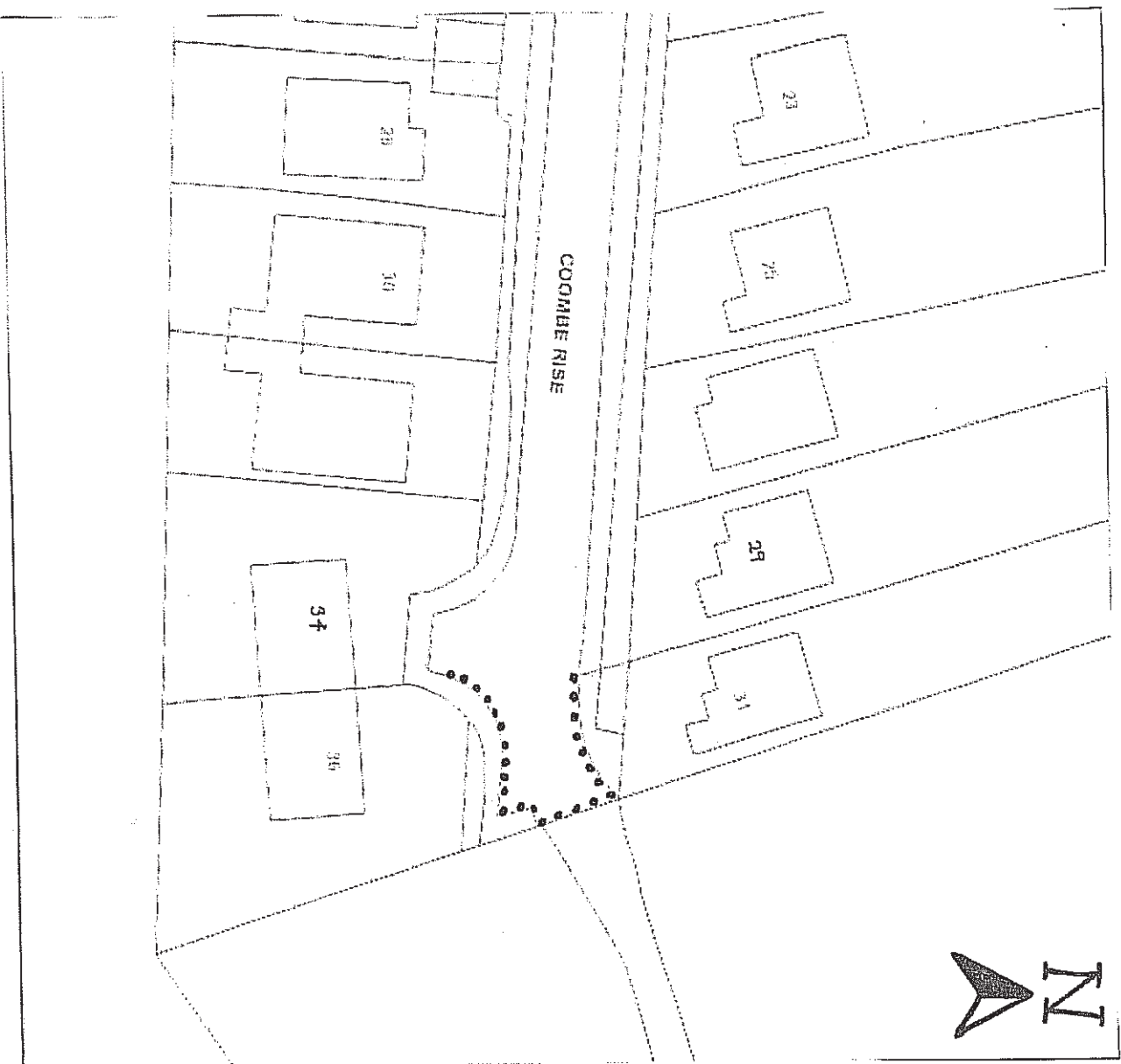

**PLAN SHOWING PROPOSED CHANGES TO PARKING RESTRICTION
COOMBE RISE, BRIGHTON**

KEY:- PROPOSED DOUBLE YELLOW LINES

REASON:- TO PREVENT OBSTRUCTION

SCALE: NOT TO SCALE REFER ONLY TO MEASUREMENTS

Please see formal notice, to see what other roads have restrictions proposed, where to view the plans and traffic order and how to object or support this proposal

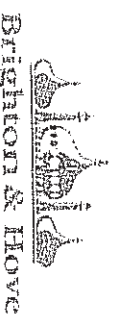

Reproduction from the Ordnance Survey mapping with the Permission of the Controller of H.M. Stationery Office. © Crown Copyright. Unauthorised reproduction infringes Crown copyright and may lead to prosecution or Civil Proceedings. Brighton & Hove Council. Licence: LA090681L, 2003.

ROTTINGDEAN COASTAL

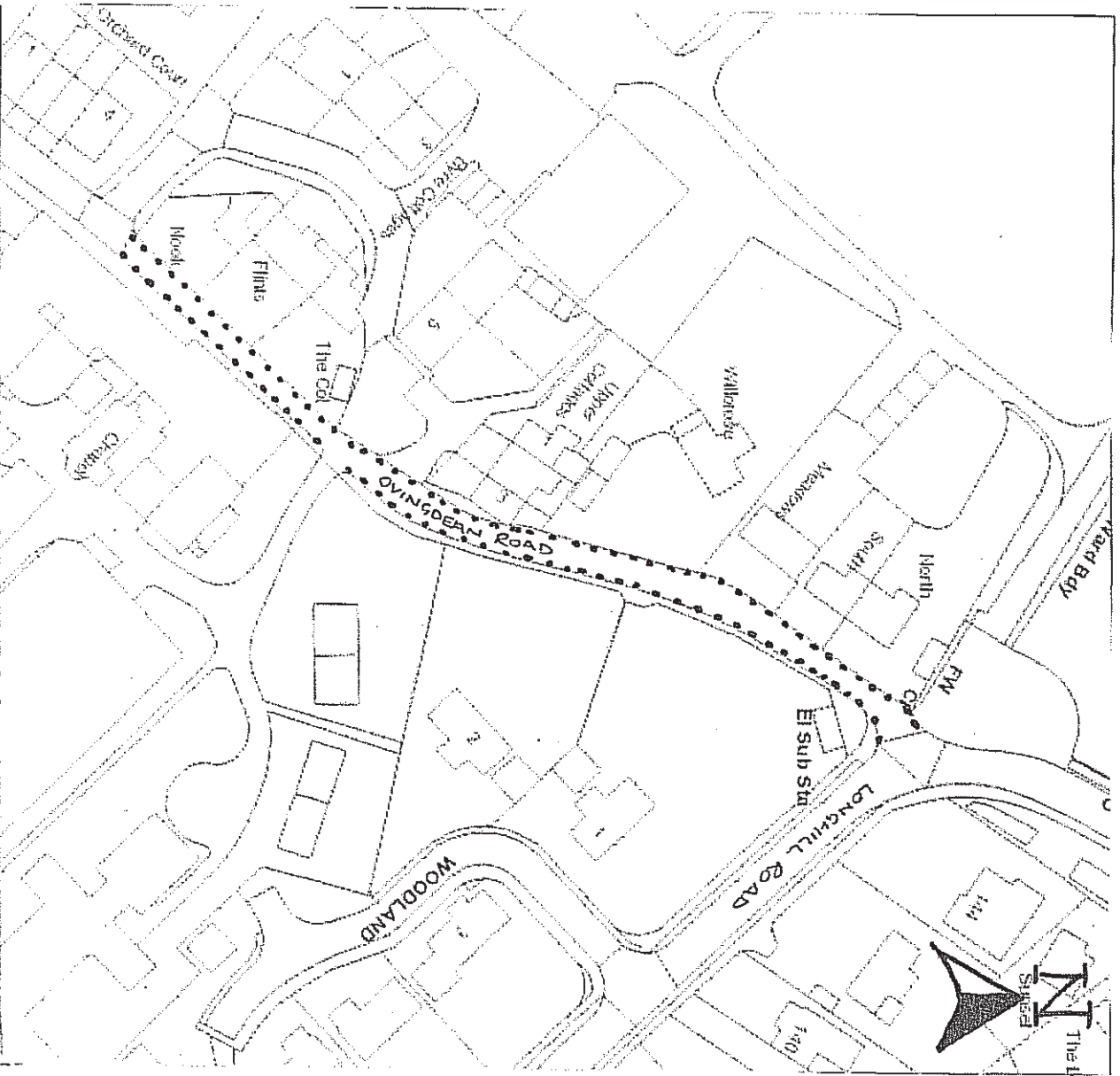

**PLAN SHOWING PROPOSED CHANGES TO PARKING RESTRICTION
OVINGDEAN ROAD, BRIGHTON**

KEY:- PROPOSED DOUBLE YELLOW LINES

REASON:- TO PREVENT OBSTRUCTION

SCALE: NOT TO SCALE REFER ONLY TO MEASUREMENTS

Please see formal notice, to see what other roads have restrictions proposed, where to view the plans and traffic order and how to object or support this proposal

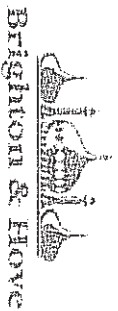

Reproduction from the Ordnance Survey mapping with the Permission of the Controller of H.M. Stationery Office. © Crown Copyright. Unauthorised reproduction infringes Crown copyright and may lead to prosecution or Civil Proceedings. Brighton & Hove Council. Licence : LA09068L. 2003.

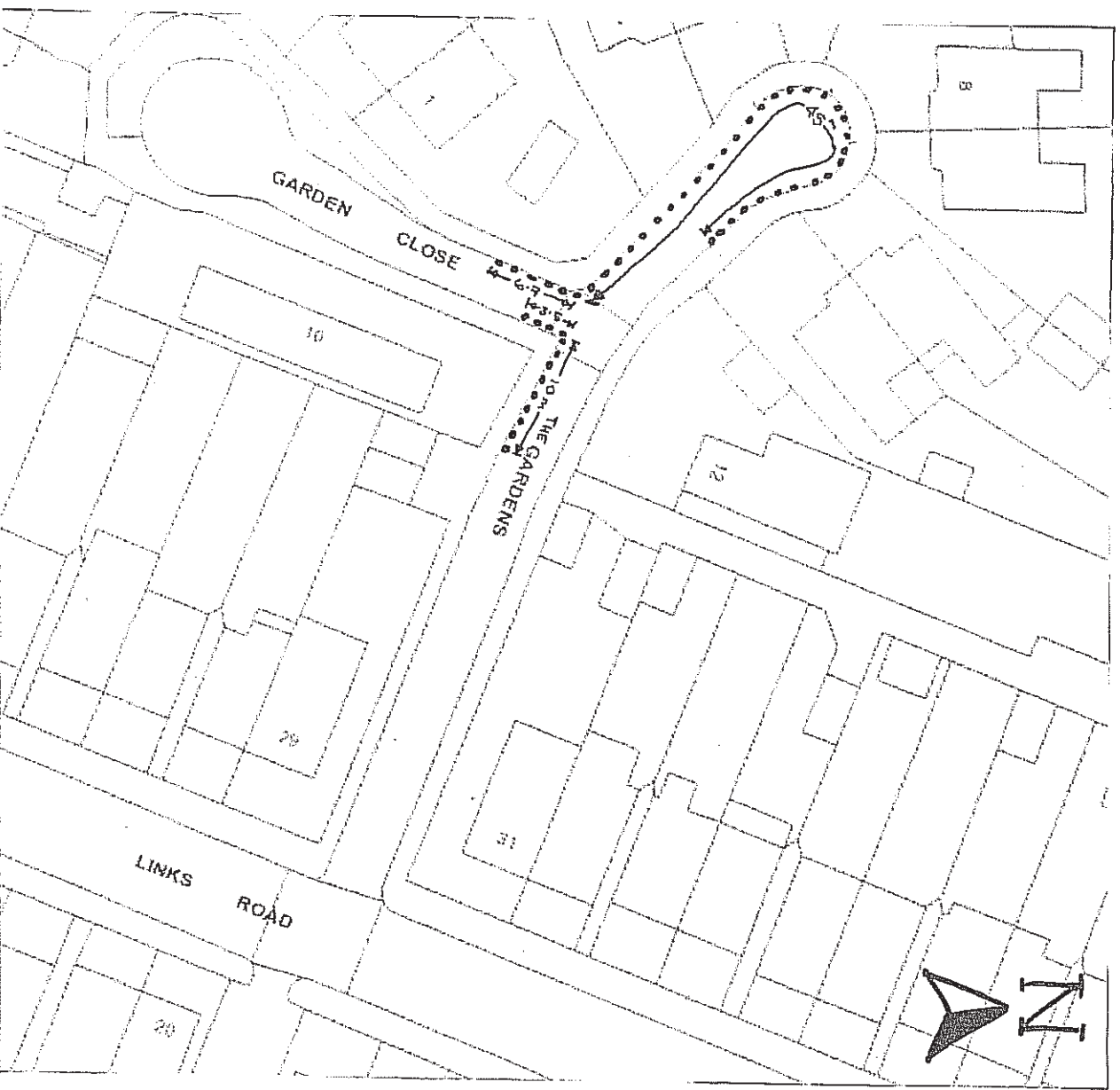

**PLAN SHOWING PROPOSED CHANGES TO PARKING RESTRICTION
GARDEN CLOSE/THE GARDENS, PORTSLADE**

KEY:- PROPOSED DOUBLE YELLOW LINES

REASON:- TO PREVENT OBSTRUCTION

SCALE : NOT TO SCALE REFER ONLY TO MEASUREMENTS

Please see formal notice, to see what other roads have restrictions proposed, where to view the plans and traffic order and how to object or support this proposal



SOUTH PORTSLADE



PLAN SHOWING PROPOSED CHANGES TO PARKING RESTRICTION

ST AUBYN'S ROAD, PORTSLADE

KEY:- PROPOSED DOUBLE YELLOW LINES

===== EXISTING DOUBLE YELLOW LINES

REASON:- TO PREVENT OBSTRUCTION

SCALE : NOT TO SCALE REFER ONLY TO MEASUREMENTS

Please see formal notice, to see what other roads have restrictions proposed, where to view the plans and traffic order and how to object or support this proposal

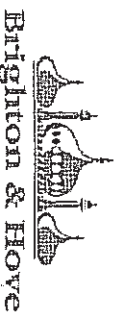

Brighton & Hove

Reproduction from the Ordnance Survey mapping with the Permission of the Controller of H.M. Stationery Office. © Crown Copyright. Unauthorised reproduction infringes Crown copyright and may lead to prosecution or Civil Proceedings. Brighton & Hove Council. Licence : LA09068L, 2003.

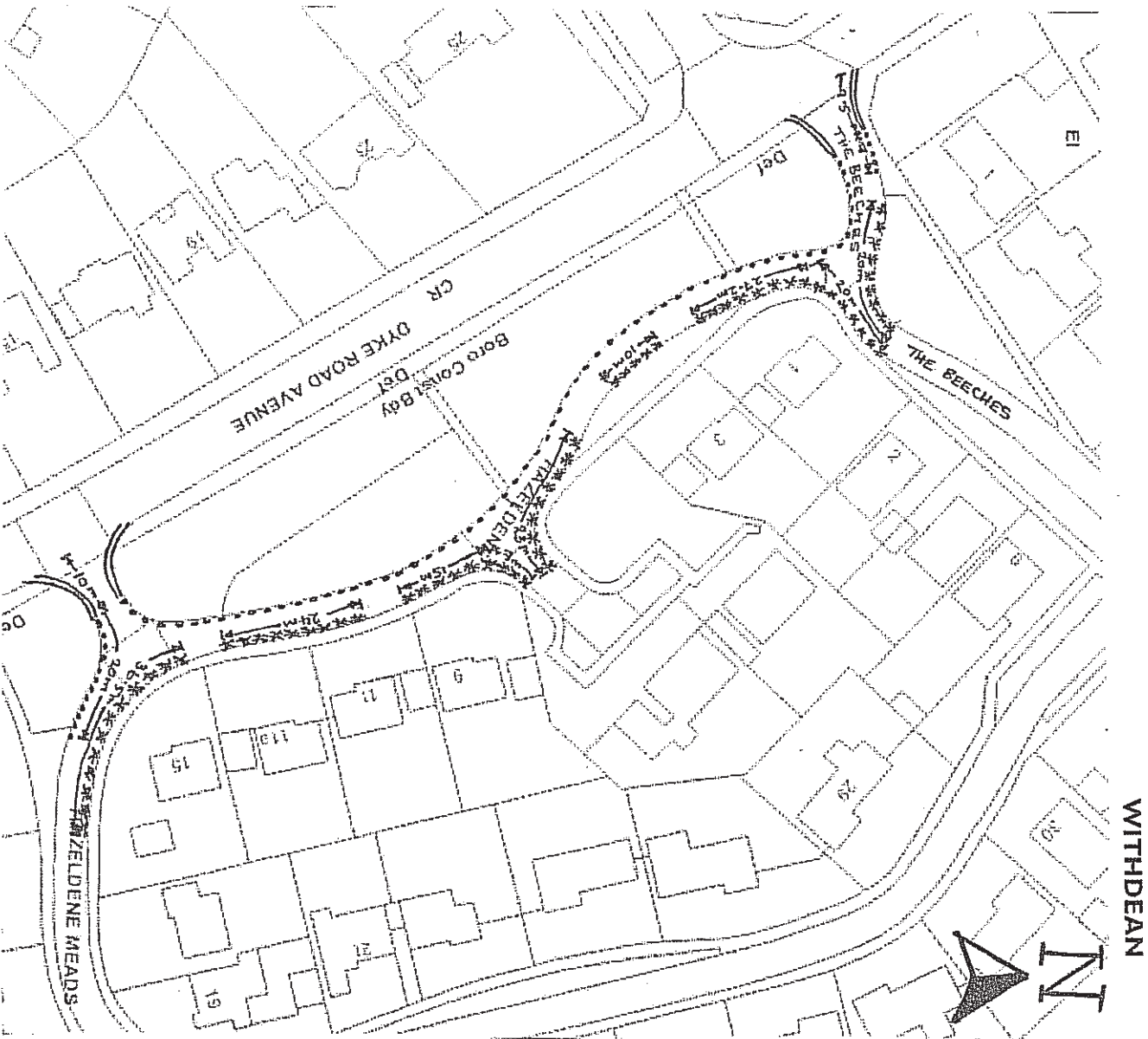

**PLAN SHOWING PROPOSED CHANGES TO PARKING RESTRICTION
HAZELDENE MEADS/THE BEECHES, HOVE**

- KEY:-** PROPOSED DOUBLE YELLOW LINES
 ===== EXISTING DOUBLE YELLOW LINES
 - - - - - PROPOSED SINGLE YELLOW LINES MONDAY TO SATURDAY 8AM TO 6PM

REASON:- TO PREVENT OBSTRUCTION

SCALE : NOT TO SCALE REFER ONLY TO MEASUREMENTS

Please see formal notice, to see what other roads have restrictions proposed, where to view the plans and traffic order and how to object or support this proposal

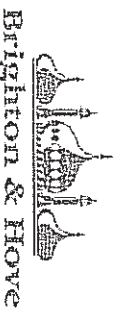

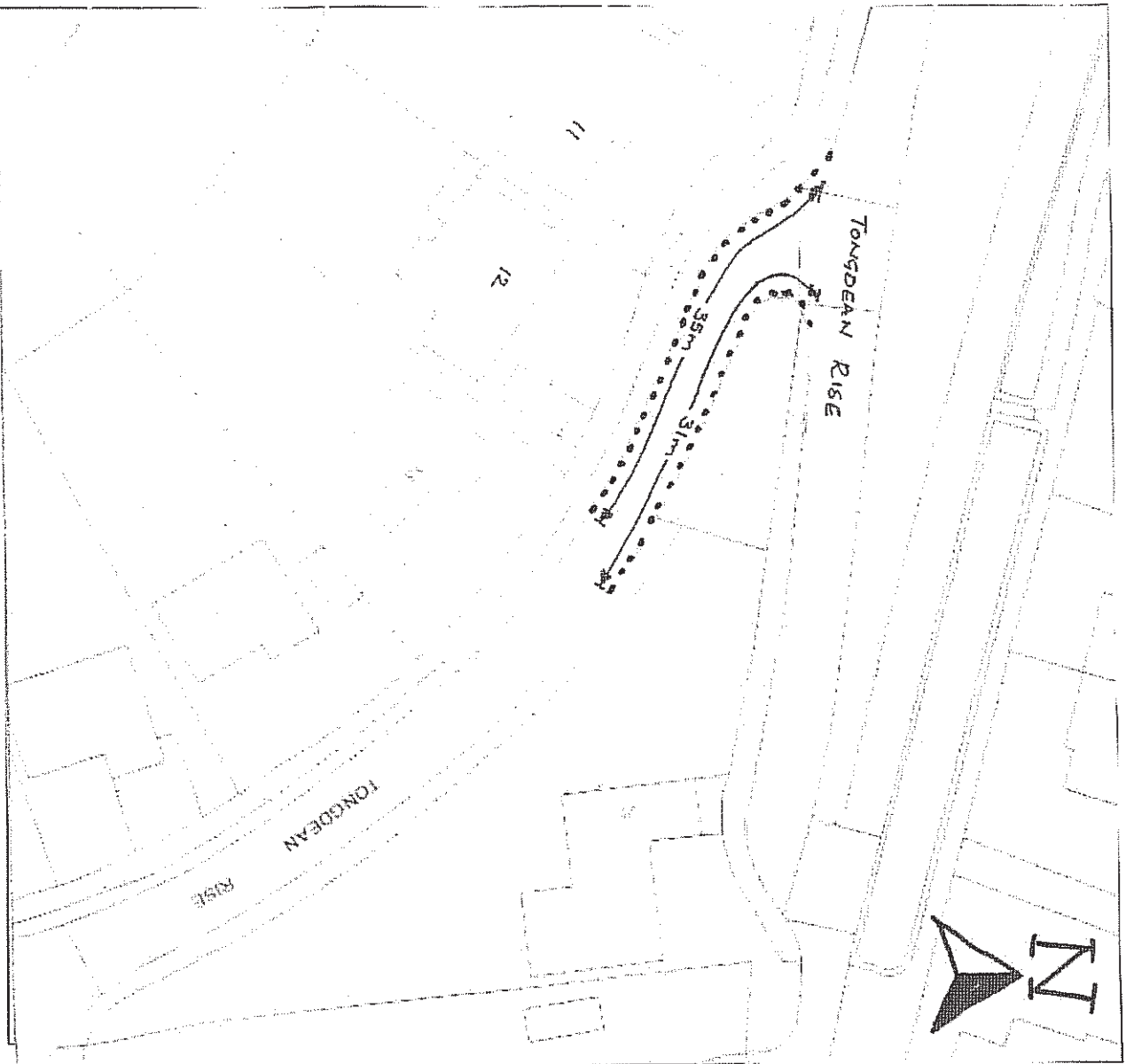

**PLAN SHOWING PROPOSED CHANGES TO PARKING RESTRICTION
TONGDEAN RISE, BRIGHTON**

KEY:- PROPOSED DOUBLE YELLOW LINES

REASON:- TO PREVENT OBSTRUCTION

SCALE : NOT TO SCALE REFER ONLY TO MEASUREMENTS

Please see formal notice, to see what other roads have restrictions proposed, where to view the plans and traffic order and how to object or support this proposal

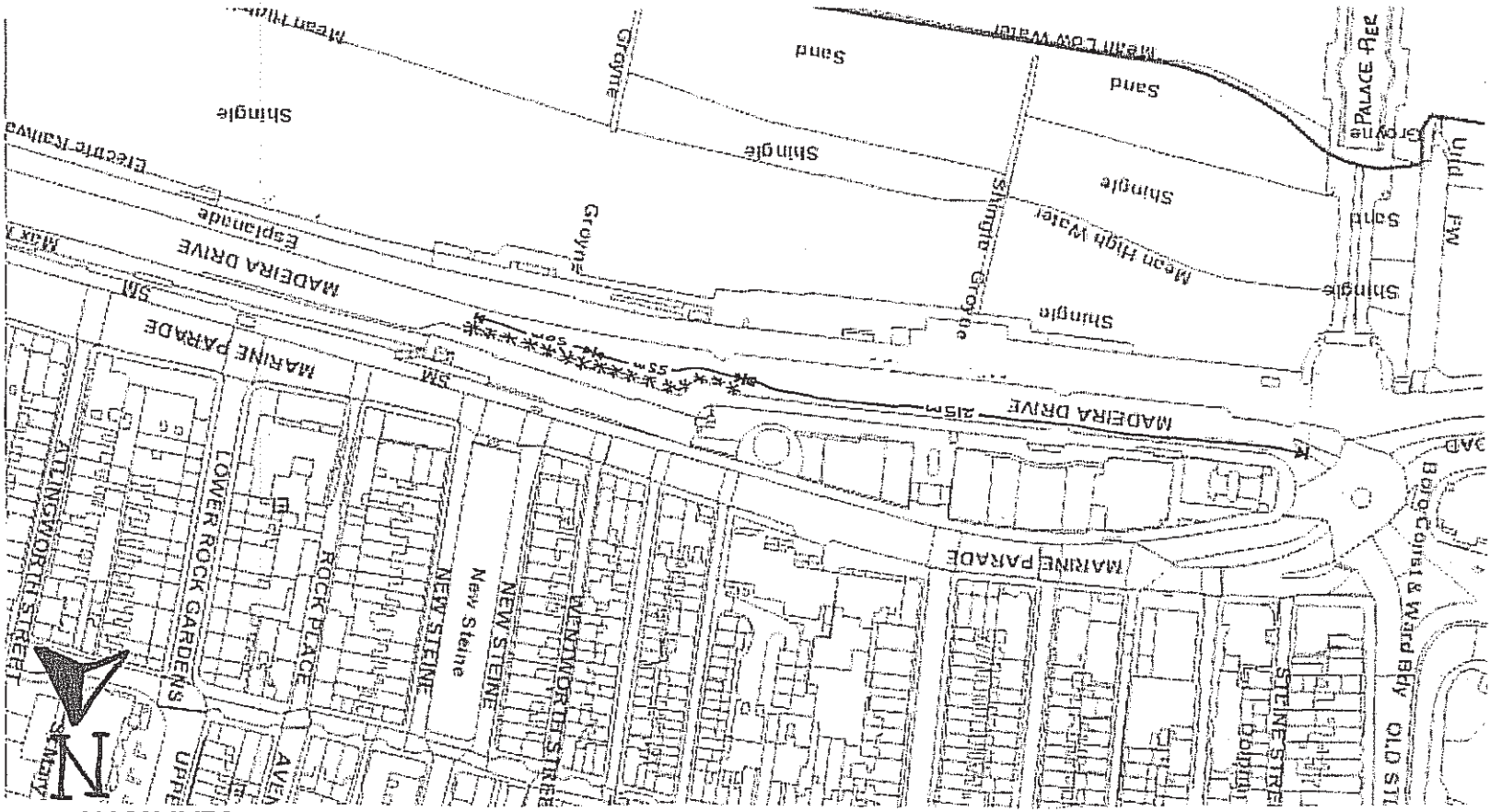

**PLAN SHOWING PROPOSED CHANGES TO PARKING RESTRICTION
MADEIRA DRIVE, BRIGHTON**

KEY: *** PROPOSED REMOVAL OF NO LOADING/UNLOADING 12 NOON TO 8 PM**



REASON:- TO ALLOW DISABLED DRIVERS TO USE NEARBY FACILITIES

SCALE : NOT TO SCALE REFER ONLY TO MEASUREMENTS

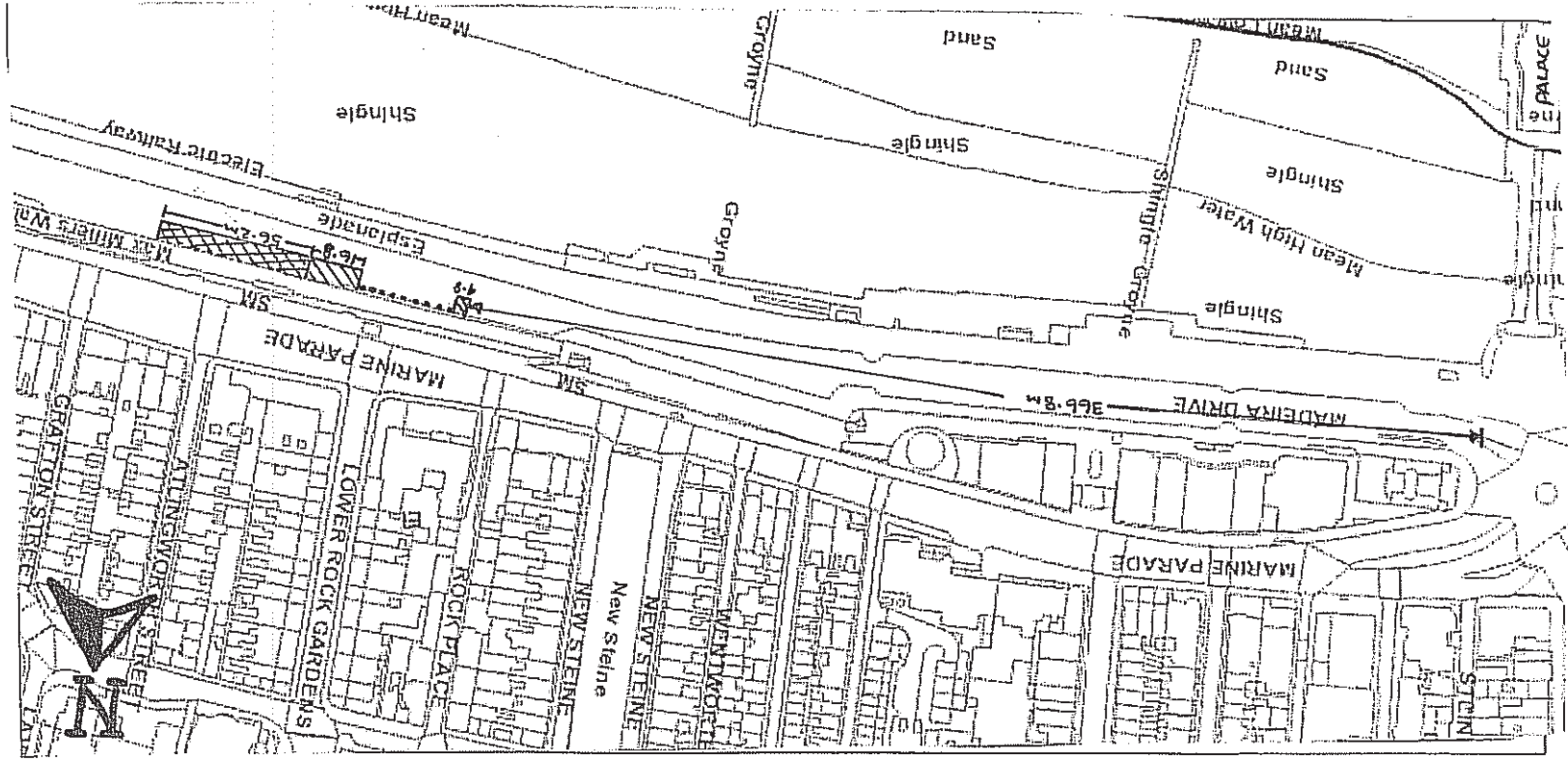
Reproduction from the Ordnance Survey mapping with the Permission of the Controller of H.M. Stationery Office. © Crown Copyright. Unauthorised reproduction infringes Crown copyright and may lead to prosecution or civil proceedings. Brighton & Hove Council. Licence : LA09068L, 2003.

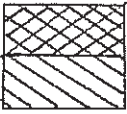

**PLAN SHOWING PROPOSED CHANGES TO PARKING RESTRICTION
MADEIRA DRIVE, BRIGHTON**

KEY:-
 PROPOSED ECHELON PAY AND DISPLAY PARKING BAYS
 PROPOSED DOUBLE YELLOW LINES
 EXISTING PAY AND DISPLAY PARKING BAYS

REASON:- REQUEST FROM A BUSINESS TO OPEN UP THE FRONTAGE IN FRON OF THE SHOPS

SCALE : NOT TO SCALE REFER ONLY TO MEASUREMENTS

Reproduction from the Ordnance Survey mapping with the Permission of the Controller of H.M. Stationery Office @ Crown Copyright. Unaudited reproduction infringes Crown copyright and may lead to prosecution or civil proceedings. Brighton & Hove Council. Licence : LA09068L, 2003.